

MAGNETIC SWITCHES

MOUNTINGS FOR FE,FF,FG SERIES AND FP ADAPTERS

General characteristics

The system for mounting these switches is based on a Tee. This is suitable for cylinders without tie-rods, cylinders with tie-rods, cylinders with shaped profile and other applications where the use of this type may be useful.

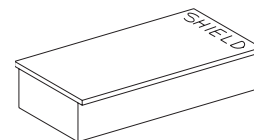

Clamps

	Simple clamp	Double clamp	Clamp with rubber
Material	nylon	nylon	nylon, rubber
C (mm)	Tolerance of C: $\pm 0,3$	Tolerance of C: $\pm 0,3$	Tolerance of C: ± 1
11,3	FA23-0113		
12	FA23-0120		
13,3	FA23-0133	FA22-0133	
14	FA23-0140		
16	FA23-0160		
17,3	FA23-0173		
18	FA23-0180		
20	FA23-0200		
21,3	FA23-0213		
24	FA23-0240		
26,3	FA23-0263		
28	FA23-0280		
30	FA23-0300		
35,5			FA21-0360
44,5			FA21-0450

Rail with bracket

	Rail	Bracket
Notes	2 meters bars. Packaging: 20 pieces	
Code	FA01-2000	FA44-0006

MAGNETIC SWITCHES

MOUNTINGS FOR FE,FF,FG SERIES AND FP ADAPTERS

Universal brackets for microcylinders and cylinders with tie-rods

Material: Polyamide + 30% glass filled; brass.
 Patented universal bracket, manufactured in 4 sizes, can be used with an extremely wide choice of cylinders with tie-roads and with any micro-cylinder on the market.
 Its resistance to high vibrations is ensured by the special coupling between screw-thread and brass band.

D = external diameter of the cylinder
 X = length of the metallic part

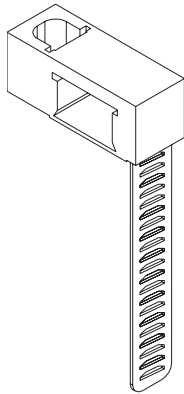

D max mm	X mm		
30	115	FA45-01	
65	225		FA45-02
125	415		FA45-03
180	615		FA45-04

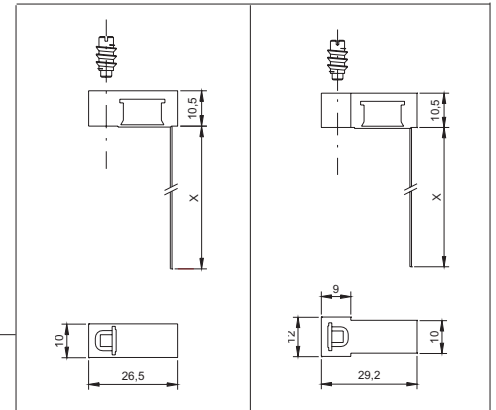

Universal brackets for cylinders with tie-rods

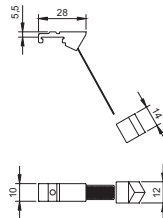
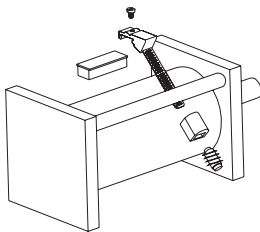

Materials: polyamide +30% glass filled; stainless steel	
Bore	Code
from 32 to 200 mm	FA49-0001
from 200 to 250 mm	FA49-0002

Low cost bracket

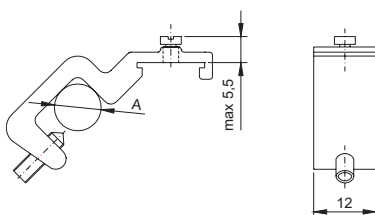

Material: aluminium		
A (mm)		Code
min	max	
4	9	FA44-0009
9	15	FA44-0015
15	20	FA44-0020

MAGNETIC SWITCHES

MOUNTINGS FOR FE,FF,FG SERIES AND FP ADAPTERS

Combined clamp FA51

Mounting system made by mazak FA48 clamp and polyamide + 30% glass filled FA47 clamp.

Characteristics of FA47 bracket

These brackets are manufactured with different angles and different lengths in order to fit perfectly all cylinders with shaped profile. For example, the chart below shows a list of cylinders on the market with the codes of the suitable clamps and brackets

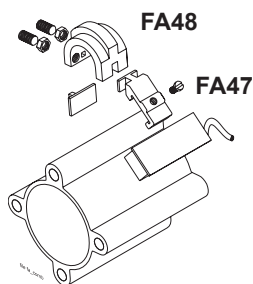

Characteristics of FA48 clamps

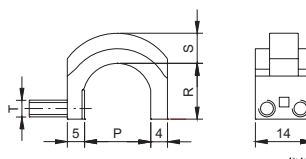

P mm	R mm	S mm	T mm	Code
12,2	12	6	M4 x 10	FA48-0011
15,5	15,5	7	M4 x 10	FA48-0012
20	19,5	7	M4 x 20	FA48-0013
26	23	7	M4 x 20	FA48-0014

Hints for the choice of FA51 combined bracket

	Cylind. bore mm.	Complete bracket	Clamp for fixing to the cylinder	Switch fixing
Eural 80 Airmatic I Alfamatic I Diottalevi I Kpm I Megliani I Tecmatic E	32	FA51-1131	FA48-0011	FA47-0031
	40	FA51-1137		
	50	FA51-1237	FA48-0012	FA47-0037
	63	FA51-1237		
	80	FA51-1237	FA48-0013	FA47-0037
	100	FA51-1337		
	125	FA51-1337	FA48-0013	FA47-0037
Alfamatic I Numatics D	32	FA51-1131	FA48-0011	FA47-0031
	40	FA51-1131	FA48-0011	FA47-0031
	50	FA51-1232	FA48-0012	FA47-0032
	63	FA51-1237		FA47-0037
	80	FA51-1238	FA48-0013	FA47-0038
	100	FA51-1238		FA47-0038
	125	FA51-1338	FA48-0013	FA47-0038
Festo D Vesta I Waircom I	32	FA51-1131	FA48-0011	FA47-0031
	40		FA48-0011	FA47-0031
	50	FA51-1237	FA48-0012	FA47-0037
	63			
	80	FA51-1337	FA48-0013	FA47-0037
	100			
	125	FA51-1337	FA48-0013	FA47-0037
Camozzi I	32	FA51-1131	FA48-0011	FA47-0031
	40	FA51-1131	FA48-0011	FA47-0031
	50	FA51-1233	FA48-0012	FA47-0033
	63	FA51-1234		FA47-0034
	80	FA51-1337	FA48-0013	FA47-0037
	100			FA48-0013
	125	FA51-1337	FA48-0013	FA47-0037
Cmb I Metra I	32	FA51-1131	FA48-0011	FA47-0031
	40			
	50	FA51-1137	FA48-0012	FA47-0037
	63			
	80	FA51-1237	FA48-0012	FA47-0037
	100			
	125	FA51-1337	FA48-0013	FA47-0037

Brand names	Cylind. bore mm.	Complete bracket	Clamp for fixing to the cylinder	Switch fixing
Eural 90 Hoerbiger D Metal Work I Silmer I Khunke	32	FA51-1131	FA48-0011	FA47-0031
	40	FA51-1131	FA48-0011	FA47-0032
	50	FA51-1232	FA48-0012	FA47-0037
	63	FA51-1237		
	80	FA51-1237	FA48-0013	FA47-0037
	100	FA51-1337		
	125	FA51-1337	FA48-0013	FA47-0037
Pneumax I	32	FA51-1131	FA48-0011	FA47-0031
	40	FA51-1137	FA48-0011	FA47-0031
	50	FA51-1237	FA48-0012	FA47-0037
	63			
	80	FA51-1337	FA48-0013	FA47-0037
	100			
	125	FA51-1337	FA48-0013	FA47-0037
Parker F	32	FA51-1231	FA48-0012	FA47-0031
	40			
	50	FA51-1237	FA48-0013	FA47-0037
	63			
	80	FA51-1337	FA48-0013	FA47-0037
	100			
	125	FA51-1337	FA48-0013	FA47-0037
Univer I	32	FA51-1131	FA48-0011	FA47-0031
	40			
	50	FA51-1333	FA48-0013	FA47-0033
	63			
	80	FA51-1334	FA48-0013	FA47-0034
	100			
	125	FA51-1334	FA48-0013	FA47-0034

MAGNETIC SWITCHES

MOUNTINGS FOR FE,FF,FG SERIES AND FP ADAPTERS

Whole bracket FA55

Metal bracket for cylinders with shaped profile. It has been designed to replace FA47 and FA48 brackets. The FA55 whole bracket is actually easier to assemble. Sizes have been studied to fit in the better way all the profile cylinders.

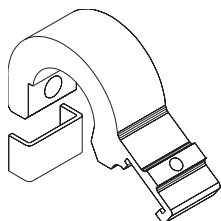
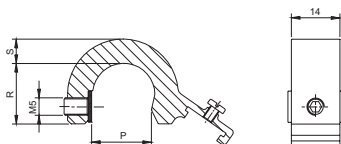

Cylinder bore	P (mm)	R (mm)	S (mm)	Code
32 / 40	11,5	12,9	6,5	FA55-03
50 / 63	17,3	17,5	7	FA55-05
80 / 100	19,3	22	8,3	FA55-08
> 100	On request, also for small quantities			

Adapters for FP switches

These adapters make FP switches universal. With all brackets and clamps is possible to mount a unique switch type on any cylinder.

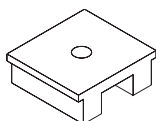

Cod. FA60-01

The FA60 adapter is of polyamide. It allows to mount FP switches in all brackets and clamps designed for FE, FF, FG series

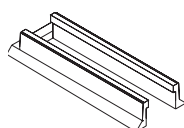

Cod. FA61-01

The FA61 adapter is of polyamide. It allows to mount FP switches in the cylinders with the groove here shown. (For which otherwise should be necessary to use FT switches)

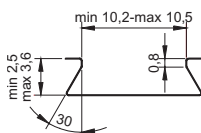

MAGNETIC SWITCHES

MOUNTINGS FOR FT SERIE

The system for mounting these switches is based on cylinders with a groove. This is generally suitable for short stroke cylinders. After insertion in the groove, the bracket and the switch are fixed by a central screw which causes the opening of the two parts. If the groove is larger than usual, the clamp set could include also a shim of plastic. For different fitting types, please contact Shield's technical office.

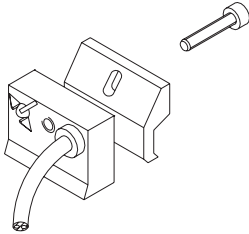

Groove on the cylinder	Metal ratchet	Metal screw	Full code
			FA52-0040

MOUNTINGS FOR SERIES FB SWITCHES

The system for mounting these switches is based on a M4 threaded nut inserted in the core of the switch itself. This is suitable for cylinders with tie-rods and other applications where the use of a threaded nut is necessary.

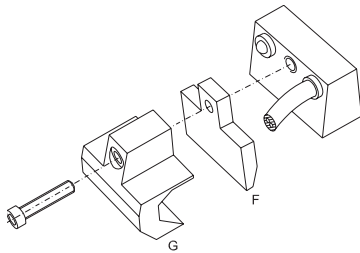

FA11 Plastic clamp

Material: polyamide + 30% glass filled
 A fixing screw, a clamp G and a shim F compose the clamp FA11.
 The shim F is used only for big cylinders, whose diameter of the tie-rod is larger than 10 mm.
 The measure A refers to the diameter of the tie-rod.

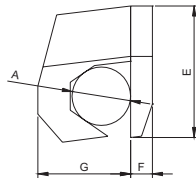

A (mm)		E (mm)	F (mm)	G (mm)	Code
min	max				
5	6	22	-	11	FA11-0506
7	8		-	15	FA11-0708
9	10		-	17	FA11-0910
11	12	27	4.5	19	FA11-1112
15	16			23	FA11-1516

MOUNTINGS FOR SERIES FI SWITCHES

The system for mounting these switches is based on a vertical hole positioned on a side. This system is suitable for cylinders or other devices with a groove suited to fit the fixing nut C.

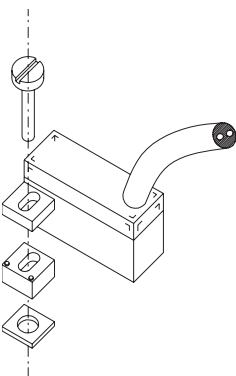

Groove on the cylinder	Brand names	Metal screw A	Nylon shim B	Metal nut C	Full code
	SMC (12-25)		-		FA53-0001
	SMC (32-100) Farbo (20-100)				FA53-0002